



## Second Circular

### STRATI 2026 – Exploring the Depths: Bridging Tradition and Innovation in Stratigraphy

We are excited to invite the global stratigraphy community to STRATI 2026 – Exploring the Depths: Bridging Tradition and Innovation in Stratigraphy, taking place from **June 28 to July 3, 2026**, at Suzhou in Jiangsu Province, China.

#### GENERAL INFORMATION

**Website:** <https://strati2026.org/>

**Contact:**

[ykshi@nju.edu.cn](mailto:ykshi@nju.edu.cn) for financial questions;

[qiwenkun@nigpas.ac.cn](mailto:qiwenkun@nigpas.ac.cn) for field excursion questions;

[yghuang@cug.edu.cn](mailto:yghuang@cug.edu.cn) for session and program questions;

[ariana.xu@nju.edu.cn](mailto:ariana.xu@nju.edu.cn) for registration questions;

[strati2026@ddeworld.org](mailto:strati2026@ddeworld.org) for other general issues.

#### CONGRESS SCHEDULE

<b>June 24<sup>th</sup> -28<sup>th</sup></b>	Pre-conference field excursions
<b>June 28<sup>th</sup></b>	Onsite registration, short courses, icebreaker
<b>June 29<sup>th</sup> -30<sup>th</sup></b>	Scientific symposia
<b>July 1<sup>st</sup></b>	Mid-conference field excursion
<b>July 2<sup>nd</sup>-3<sup>rd</sup></b>	Scientific symposia
<b>July 4<sup>th</sup>-July 10<sup>th</sup></b>	Post-conference field excursions

#### LANGUAGE

English will be the official language of the meeting and the field trips.

#### SCIENTIFIC SESSIONS

General and Subcommission sessions both include oral and poster sessions, and parallel sessions will also be scheduled. The following scientific sessions have been proposed covering a wide range of stratigraphic topics (see details on the website):

**General Sessions**

- G1. The Long Fuse to Biological Complexity: Advances in Mesoproterozoic through Cryogenian Stratigraphy
- G2. The Middle Age Period of the Earth (1.8–0.8 Ga) —New Stratigraphic Advances, Boundary Delimitation, and Planetary Spheres Interaction
- G3. Co-Evolution of Earth and Life from the Archean to the Proterozoic
- G4. The Precambrian-Cambrian Transition: Stratigraphic Record, Biological Evolution and Environmental Changes
- G5. The Palaeozoic World: Events that Shaped Life
- G6. Integrative Stratigraphy and Earth System Interactions Across the Permian-Triassic Transition
- G7. Mesozoic Timescale Calibration
- G8. Late Holocene to Anthropocene Transformations



## STRATI 2026

- G9. Cenozoic Terrestrial Biostratigraphy and Mammalian Evolution
- G10. Novel Isotope and Elemental Geochemical Proxies for Phanerozoic Stratigraphy and Ocean Chemistry Reconstructions
- G11. From the Paleotethys to the Neotethys: Insights into the Stratigraphic and Paleogeographic Evolution of the Tethys Ocean Realm
- G12. Cyclostratigraphy and Its Applications in Geochronology and Paleoclimatology
- G13. Understanding Mass Extinctions and Environmental Changes through Geological Time: Causes and Effects
- G14. The Stratigraphy of "Events" in Earth History
- G15. Trace Fossils as Indicator of Major Global Events and Regional Key Stratigraphic Surfaces
- G16. GSSP Proposals To Complete the Time Scale: Problems and Solutions
- G17. Quantitative Stratigraphy: Concepts, Principles, Methods and Applications

### **Subcommission Sessions**

- S1. Towards Subdivision of the Ediacaran System into Meaningful Stages and Series
- S2. Ordovician Stratigraphy, Ecosystem and the Habitability Evolution
- S3. Integrated Stratigraphy of the Silurian to Reconstruct Ancient Earth
- S4. Multidisciplinary Studies on Devonian
- S5. Journey to the Carboniferous
- S6. Perspectives on Permian Stratigraphy
- S7. Triassic Horizons: Multidisciplinary Approaches to Crises, Correlation and GSSPs
- S8. Tropical Seaways Through Time: Stratigraphic, Tectonic and Paleooceanographic Evolution from the Jurassic to the Neogene
- S9. Recent Advances in Jurassic Stratigraphy
- S10. Marine and Non-Marine Cretaceous Stratigraphic Correlation: New Advances and Integrated Stratigraphy for Palaeoenvironmental Reconstruction
- S11. Rapid and Gradual Global Changes: the Paleogene vs. Other Stratigraphic Intervals
- S12. Advances in Neogene Stratigraphy and Astrochronology, and the Functioning of Its Earth System
- S13. Climate Changes, Terminations, and Thresholds: Stratigraphic Markers in the Quaternary Record
- S14. 'GTS2030' – Toward an Open Science Geologic Time Scale

### **Workshops**

- W1. A Billion-Year Odyssey of the Earth's Middle Age: New Advances in the Statherian-Tonian Multi-Stratigraphy, Global Correlation and Basin Dynamics
- W2. Triassic GSSPs and the Candidates (post-conference field workshop)

### **Short Course**

Stratigraphic forward Modeling: Testing Hypotheses in Carbonate Stratigraphy

Depending on the number of oral presentations proposed, it is possible that the session organizers and the organizing committee may request poster presentations instead of oral presentations.

For abstract submission, please, visit the conference website: <https://strati2026.org/>



# STRATI 2026

## FIELD EXCURSIONS

The following excursions are scheduled (**Please purchase insurance in advance at your own expense**):

### Pre-conference Excursion

- PF1. Critical stratigraphic boundary intervals in Yunnan Province, SW China (5500 RMB)
- PF2. Late Paleozoic to earliest Mesozoic stratigraphy and faunas in Guizhou, South China (3400 RMB)
- PF3. The Yanliao and Jehol biotas in North China (4500 RMB)
- PF4. Mesoproterozoic successions in Jixian area, Tianjin City, North China (3300 RMB)

### Mid-conference Excursion

- MF1. Meishan section and Meishan Geopark (800 RMB)
- MF2. Tai Lake Xishan Section (800 RMB)
- MF3. Ordovician to Silurian strata and Anji Biota in the Anji, Zhejiang (800 RMB)

### Post-conference Excursion

- POF1. The Cryogenian-Cambrian stratigraphy and biotas in Guizhou and W. Hunan, SW China (7500 RMB)
- POF2. From Snowball Earth to Great Mass Extinction: Ediacaran to Triassic Stratigraphic Records in the Three Gorge area, central China (5000 RMB)
- POF3. Linxia Basin and Loess in North China (4000 RMB)
- POF4. Mesoproterozoic, Cambrian and terrestrial Permian-Triassic successions in the Yuntai Mountain-Shaolin Temple areas, Henan Province, central China (3500 RMB)
- POF5. Upper Devonian to lowest Carboniferous successions in Guilin Karst area, Guangxi, South China (4000 RMB)

### Post-conference Field Workshop

- W2. Workshop on Triassic GSSPs and the candidates (800 RMB)

## SOCIAL ACTIVITIES AND CONFERENCE DINNER

Social activities include the icebreaker party and reception on Sunday June 28th, as well as paid sightseeing for surrounding attractions (run by tour company).

The conference dinner will be organized on Tuesday, June 30th, at the venue with traditional Chinese performances.





# STRATI 2026

## VENUE

### Kunshan Crown International Exhibition Hotel 昆山皇冠国际会展酒店

Nestled at No. 1277 Qianjin West Road, Kunshan of Suzhou, Jiangsu Province, Kunshan Crown International Exhibition Hotel stands as a comprehensive landmark integrating grand exhibitions, conferences, accommodation, dining, and leisure. This architecturally distinctive complex comprises a 32-story main building, boasting a total construction area of 145,000 square meters. This hotel boasts 680 standard double/twin rooms and ~10 deluxe suite rooms. Several other surrounded hotels can also provide ~1000 rooms.

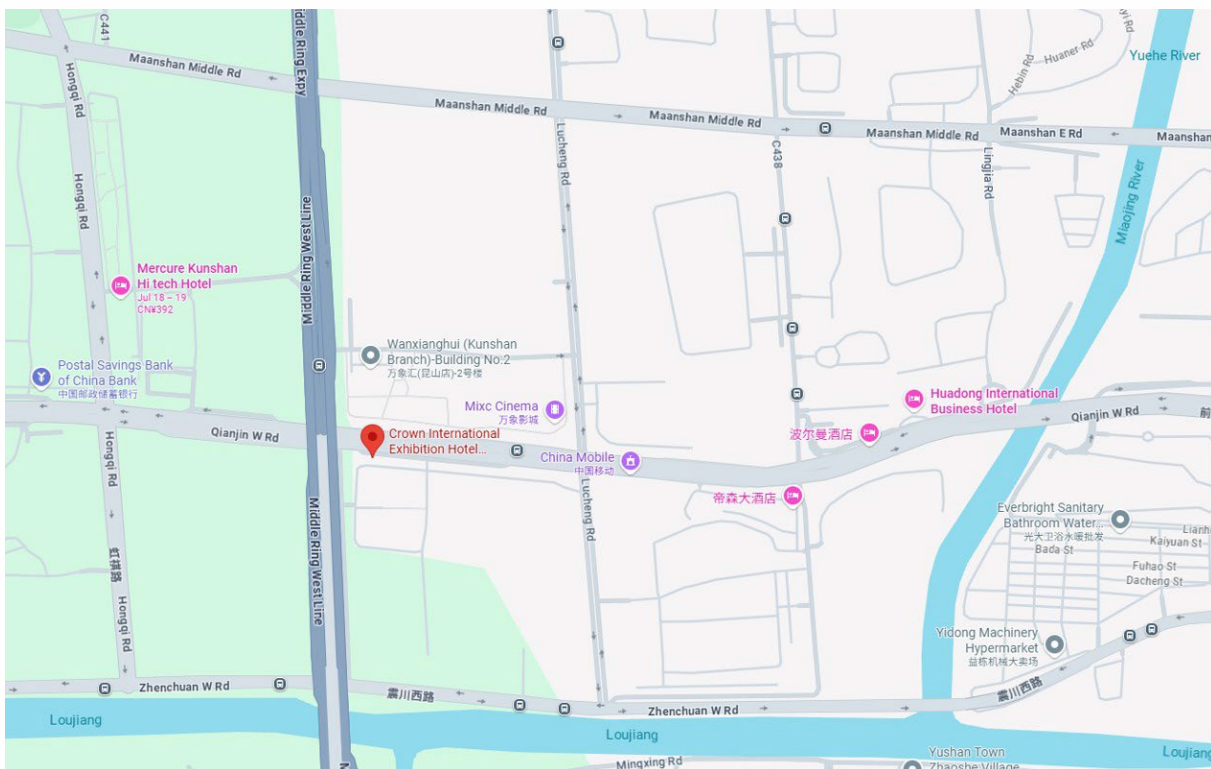

Venue location in the local map



# STRATI 2026

## ACCOMMODATIONS

### 1) Standard rooms in the same hotel with Strati (Kunshan Crown International Exhibition Hotel)

Double / twin room price: 380 RMB (~54 \$)

**In total 680 rooms for the conference have been secured as above price, on a first-come, first-served basis. All rooms are equipped with air conditioning and a desk. The accommodation offers a fitness center, two onsite restaurants and free WiFi.**



### 2) Students' accommodations in the hotels nearby

Huaqi Hotel: standard room 130 RMB (~19 \$, 1km to the venue)



ChenRan Hotel: standard room 150 RMB (~21 \$, 800m to the venue)



## STRATI 2026

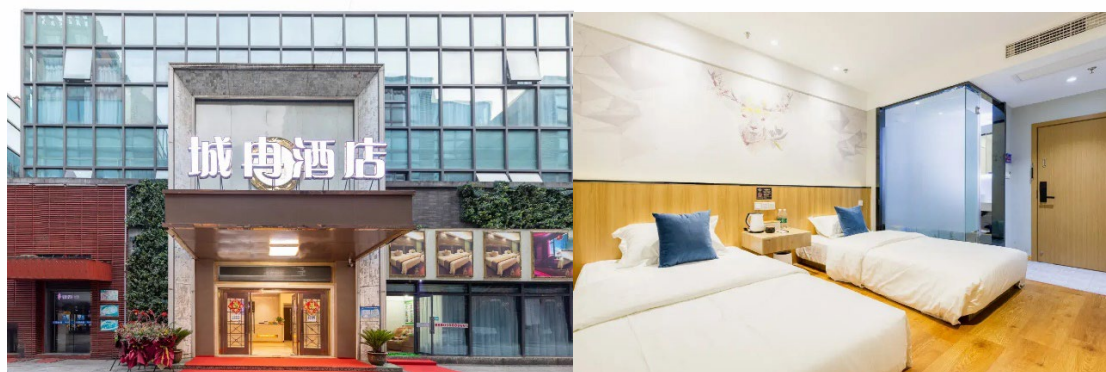

All rooms are equipped with air conditioning.  
More details will be updated on the website.

### TRAVEL

There are lots of direct flights from European, North American, Oceanian and African countries to Shanghai Pudong or Hongqiao airports (details on the Strati 2026 website), and Suzhou is next to Shanghai and has direct trains and buses access to the Shanghai Hongqiao airport (there are airport shuttle bus or Shanghai Suburban Railway Airport Link Line between Pudong and Hongqiao airports). **Shuttles will be arranged between Shanghai airports and conference venue on June 28th and July 3<sup>rd</sup> (the service can be booked with online registration).** It takes half hour from the Hongqiao airport to Suzhou. More details on the Strati 2026 website.

### VISA

Under China's current policies, citizens from **86 countries** can travel to China visa-free for up to 30 days. Additionally, citizens from **10 countries**, including European and American nations, are subject to a 10-day visa free transit policy (see details on the Strati 2026 website). Invitation letter will be provided upon request.

### REGISTRATION AND FEES

**Early-bird registration:** 2000RMB(~290\$) (professional), 1600RMB(~230\$) (retired professional), 1200RMB(~180\$) (students) **【January 31<sup>st</sup> - March 15<sup>th</sup>, 2026】**

**Standard registration:** 2900RMB(~420\$) (professional), 2200RMB(~320\$) (retired professional), 1500RMB(~220\$) (students) **【March 16<sup>th</sup> - June 27<sup>th</sup>, 2026】**

**Onsite registration:** 3300RMB(~480\$) (professional), 2500RMB(~360\$) (retired professional), 1800RMB(~260\$) (students) **【June 28<sup>th</sup>, 2026 -】**

Registration fee including icebreaker, lunch, hard copy program, digital proceedings and a bag.

**Accompanying person:** 1000 RMB (~150\$), access to icebreaker, lunch and a bag.

### IMPORTANT DATES

Dispatch of second circular: December 31<sup>st</sup>, 2025

Opening abstract submission: December 31<sup>st</sup>, 2025

Opening registration: January 31<sup>st</sup>, 2026

Deadline for abstract submission: March 15<sup>th</sup>, 2026

Deadline for early bird registration: March 15<sup>th</sup>, 2026

Dispatch of third circular: May 30<sup>th</sup>, 2026

### FEE PAYMENTS

**All fees in Strati 2026 shall be paid based on the RMB amount; the USD amount is for reference only.**